

KITTO

ACCESS

20 min walk south from Sannomiya Station (JR, Nankai and Hanshin railways)
10 min walk from Kitaoji Center Station (Port Line)
The Center does not have parking facilities so visitors are requested to use public transport.

CONTACT

Design and Creative Center Kobe (KITTO)
1-4 Sannomiya-cho, Chuo Ward, Kobe, Hyogo Prefecture, Japan 651-0082
TEL: 078-326-2201 FAX: 078-326-2230
Email: info@kitto.jp
Closed on Mondays (or on the following day if a national holiday or
National Holiday (May 1st is a Monday) and over the New Year period
Opening hours: 11:00-19:00
Admission free
http://kitto.jp/



DESIGN AND CREATIVE CENTER KOBÉ



A Center Destined for a Central Role to Drive an Era of Creativity within All.

Kobe is a city in which people of all ages live, work and play. It is also home to a special place where everyone - whether child, teenager or adult - can gather together, converse, and create new things again and again. This place is the Design and Creative Center Kobe (KITTO).

From now on, building Kobe's future will depend not only on a select group of artists and designers but also on the ideas and devices born from interaction between different kinds of people of various generations. As this form of interaction grows and gains momentum, our citizens' attachment to their home city will increase, individuality will thrive and, before long, manifest itself in the economic improvement of Kobe. Both individuals and the city itself will become more creative with KITTO playing a central role to drive this dynamic.

In the near future, starting within Kobe's Sannomiya area, an unprecedented attempt will be made to turn Kobe into a role model for urban development, both for Japan and for the wider world.

Destined to Become a Center for People, the City, and the World - The Design and Creative Center Kobe

The former "Kobe Raw Silk Testing Center" (construction completion years: Old Building 1927, New Building 1932) was renovated and opened in August, 2012 as the "Design and Creative Center Kobe". Remembering the facility's original function as a place to assess the quality of raw silk, the new center has been nicknamed "KITTO", meaning "raw silk" in Japanese.

Established in August, 2012
Site area: 8,601 m²
Total floor space: 13,779 m²



1F



MUJI+ Creative Studio

This studio operated by MUJI (Iyohin Kaikoku Co., Ltd.) carries out R&D, in collaboration with KUITO, in a wide range of fields that include disaster prevention, the environment, food, welfare, education, urban planning, and others. MUJI+ Creative Studio is also used for exhibiting the results of this R&D and for workshops. Open Thursdays, Fridays, Saturdays and Sundays between 11:00 and 19:00



Cafe

Opening date 6 hours: 12:00-18:00
This is also a base for showcasing food-related projects.

Rental Space

The KUITO Hall, Gallery and Meeting Room are available for hire. If you wish to rent any of these spaces please contact the administration office on the first floor.



KUITO HALL



Gallery A



Gallery B



101

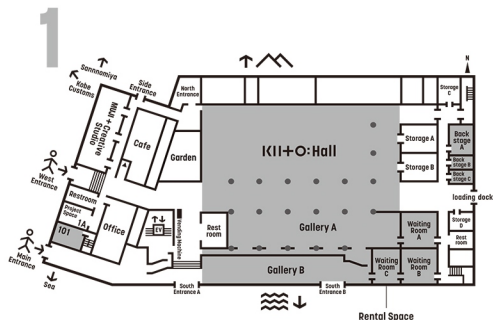

2F



Raw Silk Testing Center Museum

The KUITO buildings were originally home to the 'Nohu Raw Silk Testing Center'. The Museum introduces the history of the original Center and its silk testing methods through photographs, images and displays of actual equipment used at the time.



Library

This space houses a collection of free papers introducing the local art and design scenes of places across Japan. The Library also disseminates information on KUITO's current activities. Equipped also with a meeting area, this is a lively space fostering two-way interactive dialogue.

Rental Space



Gallery C

Experimental Utilization Space

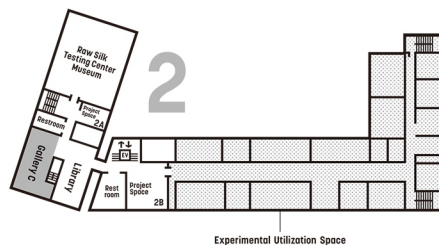

3F



Rental Space



301



303

Experimental Utilization Space

This unique space, which has been maintained in its pre-renovation condition, can be used as a production or practice space for creators. It is only open to the general public on certain specified occasions. At all other times it is off limits to ordinary visitors.



302



Creative Lab Space

4F

Creative Lab Space

The office spaces on the third and fourth floors consist of 29 rooms available for tenants (as of January 2018). If you wish to inquire for tenancy, please contact the administration office on the first floor. (*Creative Lab* rooms are off limits to ordinary visitors.)

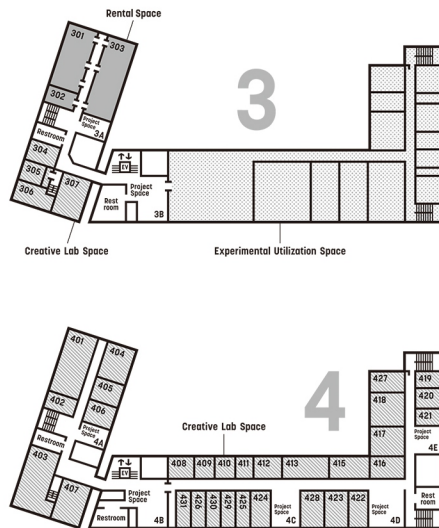

■ Rental Space ■ Creative Lab Space ■ Experimental Utilization Space